



WARNING: CHOKING HAZARD

Toy contains small parts and functional/sharp points.
Not for children under 4 years old.
Adult supervision required.



SLED WITH REINDEER

Made in Chonburi, Thailand exclusively for The Home Depot by Houseworks, Ltd
2388 Pleasantdale Road, Atlanta, GA 30340 · batch #171114 · date: 08/18

Contents:

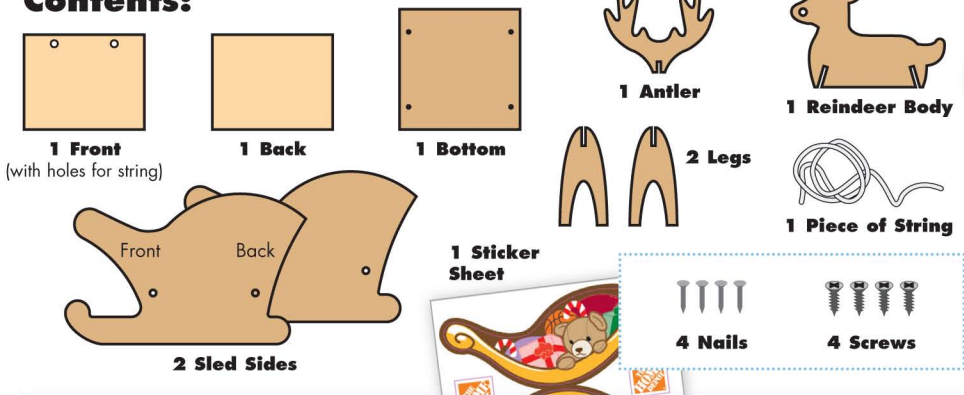

Finished example.

ALSO NEEDED:

- Safety Goggles
- Fine Sandpaper
- Wood Glue
- Hammer
- Phillips Head Screwdriver

Assembly:

Start with sanding each wood piece to remove any rough edges. Remember to sand in the direction of the wood grain. Glue and nail the pieces together. Allow glue to completely dry.

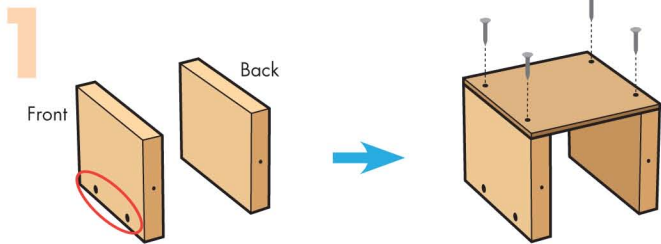

Step 1 — Stand both front and back pieces on long edges. Make sure the holes for the string in the front piece are at bottom. Glue the bottom piece on top. Make sure the nail holes are on the front and back pieces. Make sure outside edges are even. Using 4 nails, nail them together.

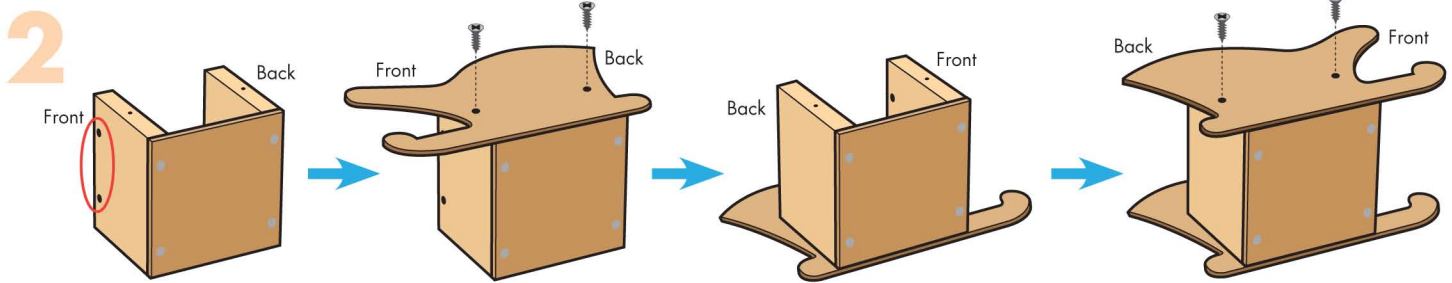

Step 2 — Turn the project on an open side. Match the holes in one sled side piece to the holes in the front and back pieces. Make sure the front edge of the sled side piece is on the front piece. Glue this sled side piece and attach securely with 2 screws. Turn the project over and repeat to attach the other side piece to form a sled.

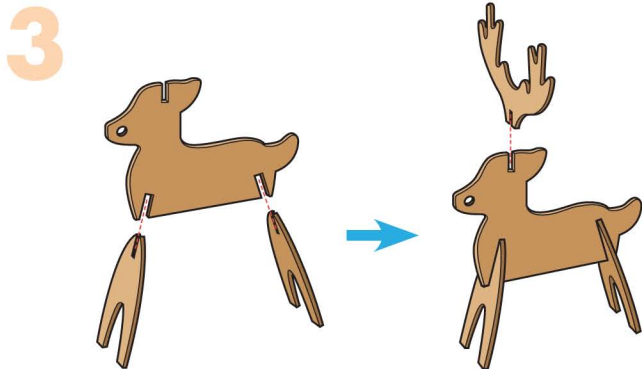

Step 3 — Add a little glue to the cutouts in the reindeer body. Fit the cutouts in the reindeer body to the cutouts in the legs and push in all the way. Fit the cutout in the reindeer body to the cutout in the antler and push in all the way to form a reindeer.

Attention: If you are painting the project, paint and wait to dry completely before adding the stickers and the string.

Step 4 — Add the stickers as shown above. Push one end of the string through the hole in the nose of the reindeer. Push each end of the string through the holes in the sled from outside. Tie the ends together inside the sled.

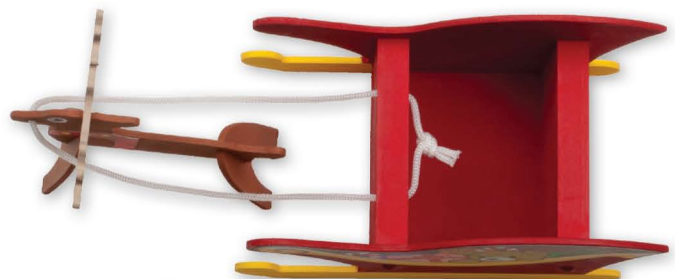

(Ver el dorso para instrucciones en español.)

California 93120 compliant for formaldehyde phase 2